

PORTAS MULTIUSO &
PUERTAS MULTIUSO / PORTES MULTI-USAGE / MULTI-PURPOSE DOORS

PORTAS CORTA-FOGO
PUERTAS CORTAFUEGO / PORTES COUPE-FEU / FIRE DOORS



PORTA MULTIUSO - UM FOLHA

PUERTA MULTIUSO - UNA HOJA
PORTE MULTI-USAGE - UNE VANTAIL
MULTI-PURPOSE DOOR - ONE LEAF

Com ou sem ventilação e lacada a branco (RAL 9010)

Con o sin ventilación y lacado blanco (RAL 9010)

Avec ou sans ventilation et laqué blanc (RAL 9010)

With or without ventilation and white coated (RAL 9010)



DIMENSÕES E PREÇOS / DIMENSIONES Y PRECIOS / DIMENSIONS ET PRIX / DIMENSIONS AND PRICES

| | Medidas de obra Medida de obra Mesures de l'ouverture Site dimensions (mm) | Medidas da folha Medida de hoja Mesures des vantaux Leaf dimensions (mm) | Medidas de passagem Medida de paso libre Mesures de passage doorway clearance (mm) | Peso Peso Poids Weight (Kg) | Referência (Esquerda / Direita) Referencia (izquierda / derecha) Référence (gauche / droite) Reference (Left / Right) | Preço Precio Prix Price |
|---|--|--|--|---|--|----------------------------------|
| Sem ventilação Sin ventilación Sans ventilation Without ventilation | 700 x 2015 | 640 x 1974 | 620 x 1970 | 19 | 07.101070 / 07.101073 | — |
| | 800 x 2015 | 740 x 1974 | 720 x 1970 | 20 | 07.101080 / 07.101083 | — |
| | 900 x 2015 | 840 x 1974 | 820 x 1970 | 21 | 07.101090 / 07.101093 | — |
| Com ventilação Con ventilación Avec ventilation With ventilation | 700 x 2015 | 640 x 1974 | 620 x 1970 | 19 | 07.102070 / 07.102073 | — |
| | 800 x 2015 | 740 x 1974 | 720 x 1970 | 20 | 07.102080 / 07.102083 | — |
| | 900 x 2015 | 840 x 1974 | 820 x 1970 | 21 | 07.102090 / 07.102093 | — |

MEDIDAS / MEDIDAS / MESURES / MEASURES

Secção horizontal

Sección horizontal
Section horizontale
Horizontal section

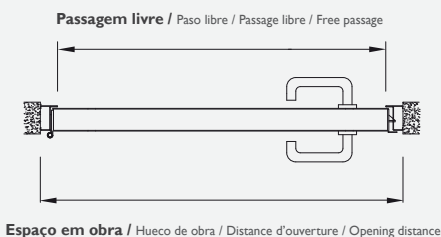

Secção vertical

Sección vertical
Section verticale
Vertical section

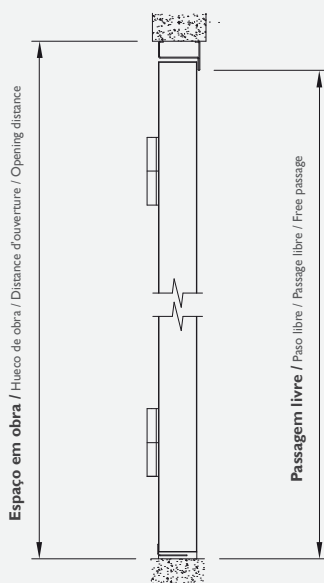

Pormenor da moldura normal

Detalle de marco "estándar"
Détail d'cadre normal
Normal frame detail

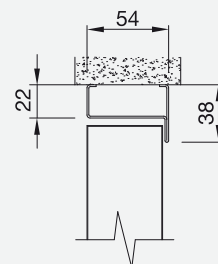

Pormenor da moldura "em caixa"

Detalle de marco "en caja"
Détail d'cadre "en boîte"
Detail of "in box" frame

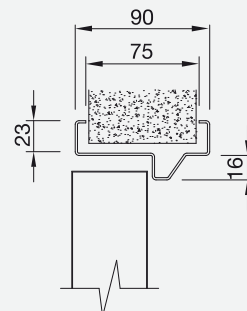



PORTA MULTIUSO - DUAS FOLHAS

PUERTA MULTIUSO - DOS HOJAS
PORTE MULTI-USAGE - DEUX VANTAUX
ULTI-PURPOSE DOOR - TWO LEAFS

Com ventilação e lacada a branco (RAL 9010)

Con ventilación y lacado blanco (RAL 9010)
Avec ventilation et laqué blanc (RAL 9010)
With ventilation and white coated (RAL 9010)



DIMENSÕES E PREÇOS / DIMENSIONES Y PRECIOS / DIMENSIONS ET PRIX / DIMENSIONS AND PRICES

| | Medidas de obra Medida de obra Mesures de l'ouverture Site dimensions (mm) | Medidas da folha Medida de hoja Mesures des vantaux Leaf dimensions (mm) | Medidas de passagem Medida de paso libre Mesures de passage doorway clearance (mm) | Peso Peso Poids Weight (Kg) | Referência (Esquerda / Direita) Referencia (izquierda / derecha) Référéncie (gauche / droite) Reference (Left / Right) | Preço Precio Prix Price |
|--|---|---|---|--|--|---|
| Com ventilação Con ventilación Avec ventilation With ventilation | 1350 x 2015 | (640+640) x 1974 | 1270 x 1970 | 29 | 07.135110 | — |
| | 1450 x 2015 | (640+740) x 1974 | 1370 x 1970 | 32 | 07.145110 | — |
| | 1550 x 2015 | (740+740) x 1974 | 1470 x 1970 | 35 | 07.155110 | — |
| | 1750 x 2015 | (840+840) x 1974 | 1670 x 1970 | 41 | 07.175110 | — |

Portas com duas folhas têm sempre ventilação / Puertas con dos hojas son siempre ventiladas / Portes avec deux vantaux, soulement avec ventilation / Door with two leafs are always ventilated

MEDIDAS / MEDIDAS / MESURES / MEASURES

Secção horizontal

Sección horizontal
Section horizontale
Horizontal section

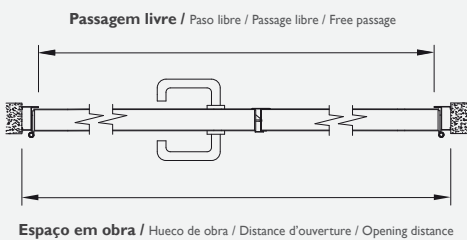

Secção vertical

Sección vertical
Section verticale
Vertical section

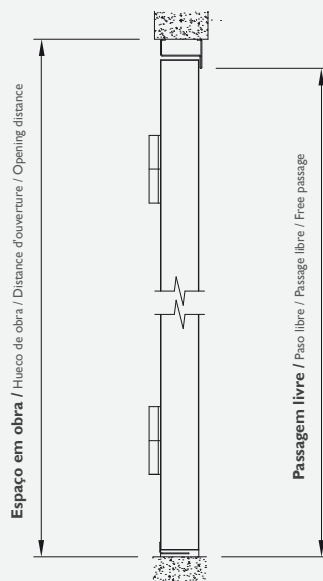

Pormenor inferior (chão)

Detalle inferior (suelo)
Détail inférieur (sol)
Inferior detail (floor)

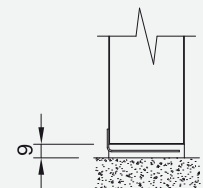

Pormenor da moldura normal

Detalle de marco "estándar"
Détail d'cadre normal
Normal frame detail

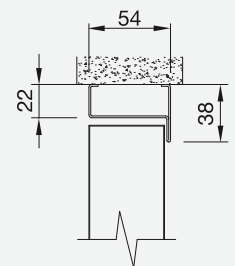

Os preços apresentados podem sofrer alterações sem aviso prévio. / Los precios mostrados pueden cambiar sin previo aviso. / Les prix indiqués peuvent changer sans préavis. / Prices shown may change without notice.

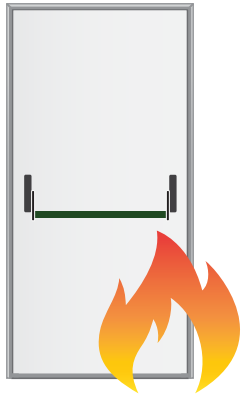

PORTA CORTA-FOGO - 60 MINUTOS
PUERTA CORTAFUEGO - 60 MINUTOS
PORTE COUPE-FEU - 60 MINUTES
FIRE DOOR - 60 MINUTES

Um ou duas folhas e lacada a branco (RAL 9010)

Una o dos hojas y lacado blanco (RAL 9010)
 Une ou deux vantaux et laqué blanc (RAL 9010)
 One or two leaves and white coated (RAL 9010)



DIMENSÕES E PREÇOS / DIMENSIONES Y PRECIOS / DIMENSIONS ET PRIX / DIMENSIONS AND PRICES

| | Medidas de obra Medida de obra Mesures de l'ouverture Site dimensions (mm) | Medidas da folha Medida de hoja Mesures des vantaux Leaf dimensions (mm) | Medidas de passagem Medida de paso libre Mesures de passage doorway clearance (mm) | Peso Peso Poids Weight (Kg) | Referência (Esquerda / Direita) Referencia (izquierda / derecha) Référence (gauche / droite) Reference (Left / Right) | Preço Precio Prix Price |
|---|---|---|---|--|---|---|
| Uma folha Una hoja Une vantail One leaf | 800 x 2070 | 755 x 2039 | 730 x 2030 | 49 | 08.200800 / 08.200802 | — |
| | 900 x 2070 | 855 x 2039 | 830 x 2030 | 53 | 08.200900 / 08.200902 | — |
| | 1000 x 2070 | 955 x 2039 | 930 x 2030 | 57 | 08.201000 / 08.201002 | — |
| Duas folhas Dos hojas Deux vantaux Two leaves | 1200 x 2070 | (755+403) x 2039 | 1126 x 2010 | 76 | 08.121010 | — |
| | 1400 x 2070 | (655+703) x 2039 | 1326 x 2010 | 85 | 08.141010 | — |
| | 1600 x 2070 | (755+803) x 2039 | 1526 x 2010 | 94 | 08.161010 | — |
| | 1800 x 2070 | (855+903) x 2039 | 1726 x 2010 | 103 | 08.181010 | — |
| | 2000 x 2070 | (955+1003) x 2039 | 1926 x 2010 | 112 | 08.201010 | — |

MEDIDAS / MEDIDAS / MESURES / MEASURES

Secção horizontal

Sección horizontal
 Section horizontale
 Horizontal section

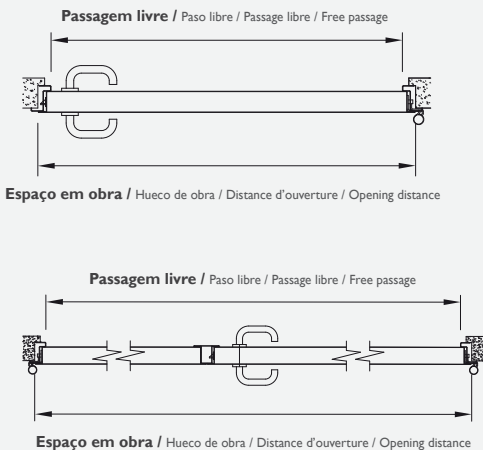

Secção vertical

Sección vertical
 Section verticale
 Vertical section

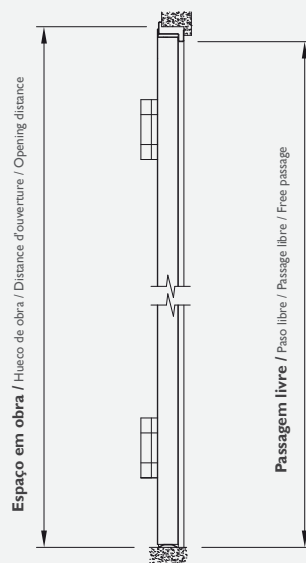

Pormenor inferior (chão)

Detalle inferior (suelo)
 Détail inférieur (sol)
 Inferior detail (floor)

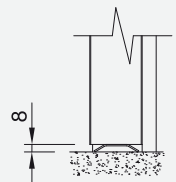

Pormenor da placa intumescente

Detalle de junta intumescente
 Détail d'la plaque intumescent
 Intumescent plate detail

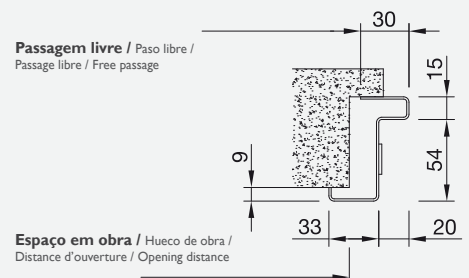



ACESSÓRIOS

ACCESORIOS
ACCESSOIRES
ACCESSORIES

Personalize a sua porta com várias opções disponíveis

Personalice la puerta con varias opciones disponibles
Personnalisez votre porte avec plusieurs options disponibles
Personalize your door with several options available



BARRA ANTI-PÂNICO

BARRA ANTIPÁNICO
BARRE ANTI-PANIQUE
PANIC BAR



PUXADOR C/ CILINDRO

MANILLA C/ BOMBILLO
POIGNÉE A/ CYLINDRE
HANDLE W/ CYLINDER



OLHO DE BOI C/ VIDRO

OJO DE BUEY C/ VIDRIO
FENÊTRE RONDE A/ VERRE
WINDOW ROUND W/ GLASS

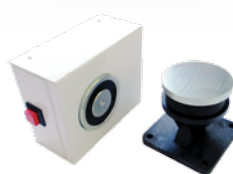

ELECTROÍMAN

ELECTROIMÁN
ÉLECTRO-AIMANT
ELECTRO-MAGNET



SELECTOR DE FECHO

SELECTOR DE CIERRE
SÉLECTEUR DE FERMETURE
DOOR COORDINATORS

OPÇÕES E CONFIGURAÇÕES / OPCIONES Y CONFIGURACIONES / OPTIONS ET REGLAGES / OPTIONS AND SETTINGS

| | | |
|--|-----------|-----------|
| Kit barra anti-pânico simples, preto/verm., puxador e cilindro / Kit barra anti-pânico simple, negro/rojo, manilla y bombillo / Kit barre anti-panique simple, noir/rouge poignée et cylindre / Simple anti-panic bar kit, black/red, handle and cylinder | 11.100113 | — |
| Kit barra anti-pânico dupla / Kit barra antipánico dupla / Kit barre anti-panique double / Double kit panic bar | 11.100015 | — |
| Fechadura p/ barra anti-pânico / Cerradura p/ barra antipánico / Serrure p/ anti-panique / Lock fl/ panic bar | 11.100017 | — |
| Conjunto puxador multiuso c/ cilindro / Conjunto manilla multiuso c/ bombillo / Set poignée multi-usage a/ cylindre / Multi-purpose handle set w/ cylinder | 11.100019 | — |
| Conjunto puxador corta-fogo c/ cilindro / Conjunto manilla cortafuego c/ bombillo / Set poignée coupe-feu a/ cylindre / Fire door handle set w/ cylinder | 11.100020 | — |
| Fechadura p/ porta corta-fogo / Cerradura p/ puerta cortafuego / Serrure p/ porte coupe-feu / Lock fl/ fire door | 11.100021 | — |
| Mola de fecho c/ braço articulado / Cierrapuertas c/ brazo de tijera / Ferme-porte à bras articulé / Closing spring w/ articulated arm | 11.100023 | — |
| Kit olho de boi c/ vidro, c/ colocação / Kit ojo de buey c/ vidrio, c/ colocación / Kit fenêtre ronde a/ verre, a/ placement / Window round w/ glass kit, w/ placing | 11.100025 | — |
| Kit olho de boi c/ vidro / Kit ojo de buey c/ vidrio / Kit fenêtre ronde a/ verre / Window round w/ glass kit | 11.100026 | — |
| Eixo simples p/ dobradiça corta-fogo / Eje simple p/ bisagra cortafuego / Axe simple p/ charnière coupe-feu / Simple axle fl/ fire door hinge | 11.100031 | — |
| Eixo c/ mola p/ dobradiça corta-fogo / Eje c/ muelle p/ bisagra cortafuego / Axe a/ ressort p/ charnière coupe-feu / Spring axle fl/ fire door hinge | 11.100032 | — |
| Mola de fecho c/ braço deslizante / Cierrapuertas c/ brazo deslizante / Ferme-porte à bras glissière / Closing spring w/ sliding arm | 11.100033 | — |
| Selector de fecho p/ C.F de 2F / Selector de cierre p/ CF de 2H / Sélecteur de fermeture p/ C-F de 2V / Door coordinators fl/ 2D FD | <900mm | 11.100034 |
| Selector de fecho p/ C.F de 2F / Selector de cierre p/ CF de 2H / Sélecteur de fermeture p/ C-F de 2V / Door coordinators fl/ 2D FD | >900mm | 11.100035 |

ABERTURA / APERTURA / OUVERTURE / OPENING

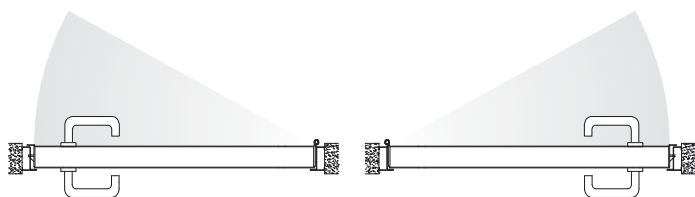

A mão da porta é sempre vista no sentido da fuga

La mano de la puerta siempre se ve en la dirección de salida
La main de la porte est toujours vu dans le sens de la fuite
The door hand is always seen in the direction of escape

INTERIOR / INTERIOR / INTÉRIEUR / INTERIOR



Porta Multiuso: em material ecológico

Puerta multiuso: en material ecológico
Porte multi-usage: en matériau écologique
Fire door: in ecological material



Porta Corta-fogo: em lâ de rocha

Puerta cortafuego: en lana de roca
Porte coupe-feu: en laine de roche
Porta Corta-fogo: in glass wool

Os preços apresentados podem sofrer alterações sem aviso prévio. / Los precios mostrados pueden cambiar sin previo aviso. / Les prix indiqués peuvent changer sans préavis. / Prices shown may change without notice.



20.000 m²

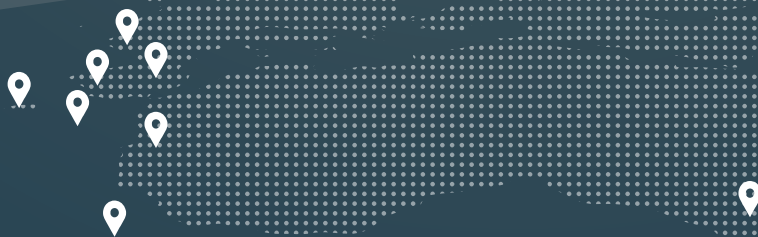

LM Perfis - Indústria de Perfis e Portas, S.A.

Zona Industrial do Camporês, Lts. 26/27
3240 - 509 Chão de Couce - Ansião
Portugal

Tel: +351 236 620 170
Fax: + 351 236 620 176
E-mail: geral@lmpenfis.pt



*DESDE 1993
A DESENVOLVER
O MELHOR
PARA SI*